

NONE

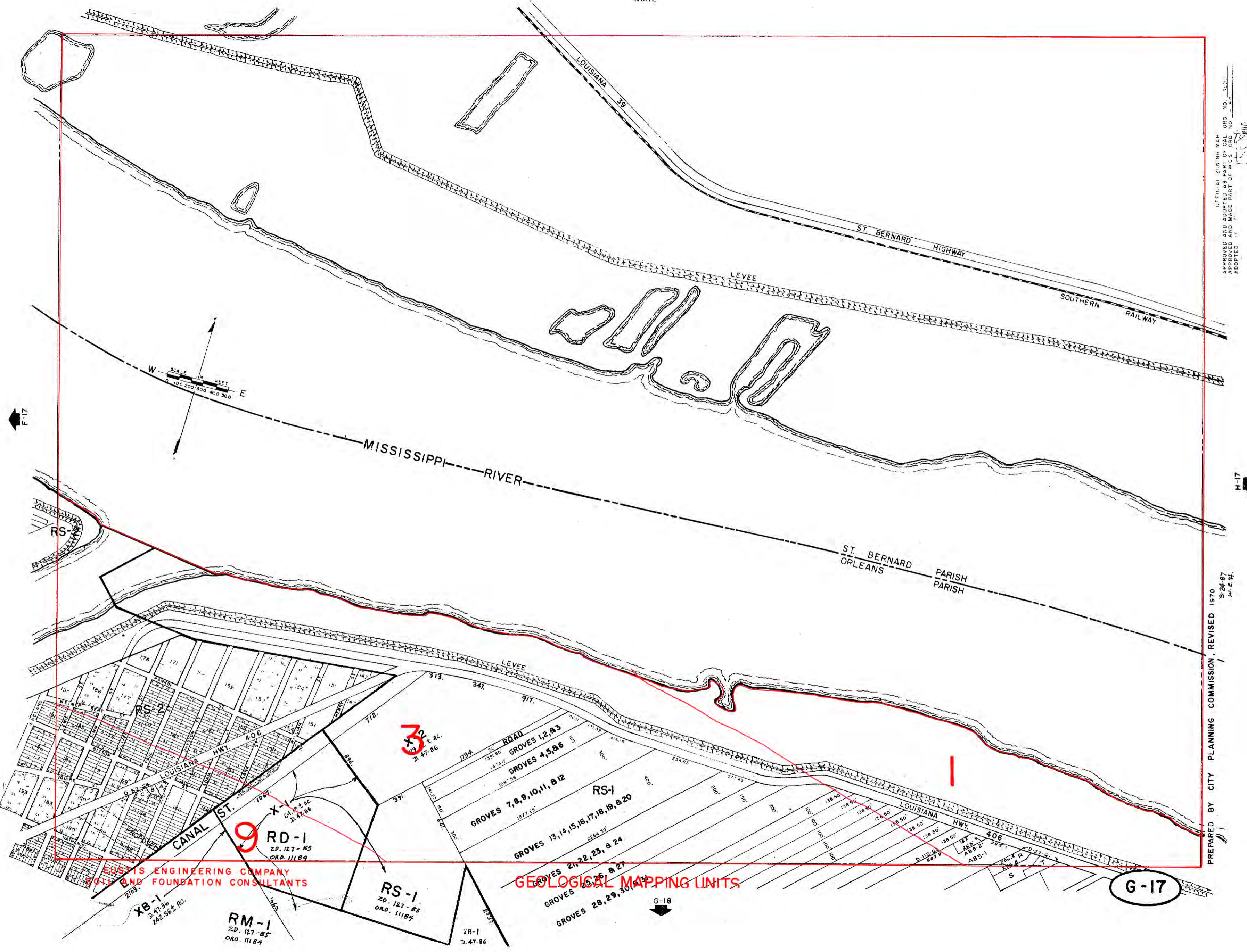

OFFICIAL ZONING MAP  
 APPROVED AND ADOPTED AS PART OF CAL. ORD. NO. 31,211  
 AND MADE PART OF W.C. ORD. NO. 2,211  
 ADDED.

3-24-87  
 J.W.E.H.

PREPARED BY CITY PLANNING COMMISSION, REVISED 1970

EUSTIS ENGINEERING COMPANY  
 SOILS AND FOUNDATION CONSULTANTS

GEOLOGICAL MAPPING UNITS

G-17