

NONE

OFFICIAL ZONING MAP
APPROVED AND ADOPTED AS PART OF CAL. ORD. NO. 4599
APPROVED AND MADE PART OF M.C.S. ORD. NO. 4264
ADOPTED 4/23/70
MAYOR

LAKE PONTCHARTRAIN

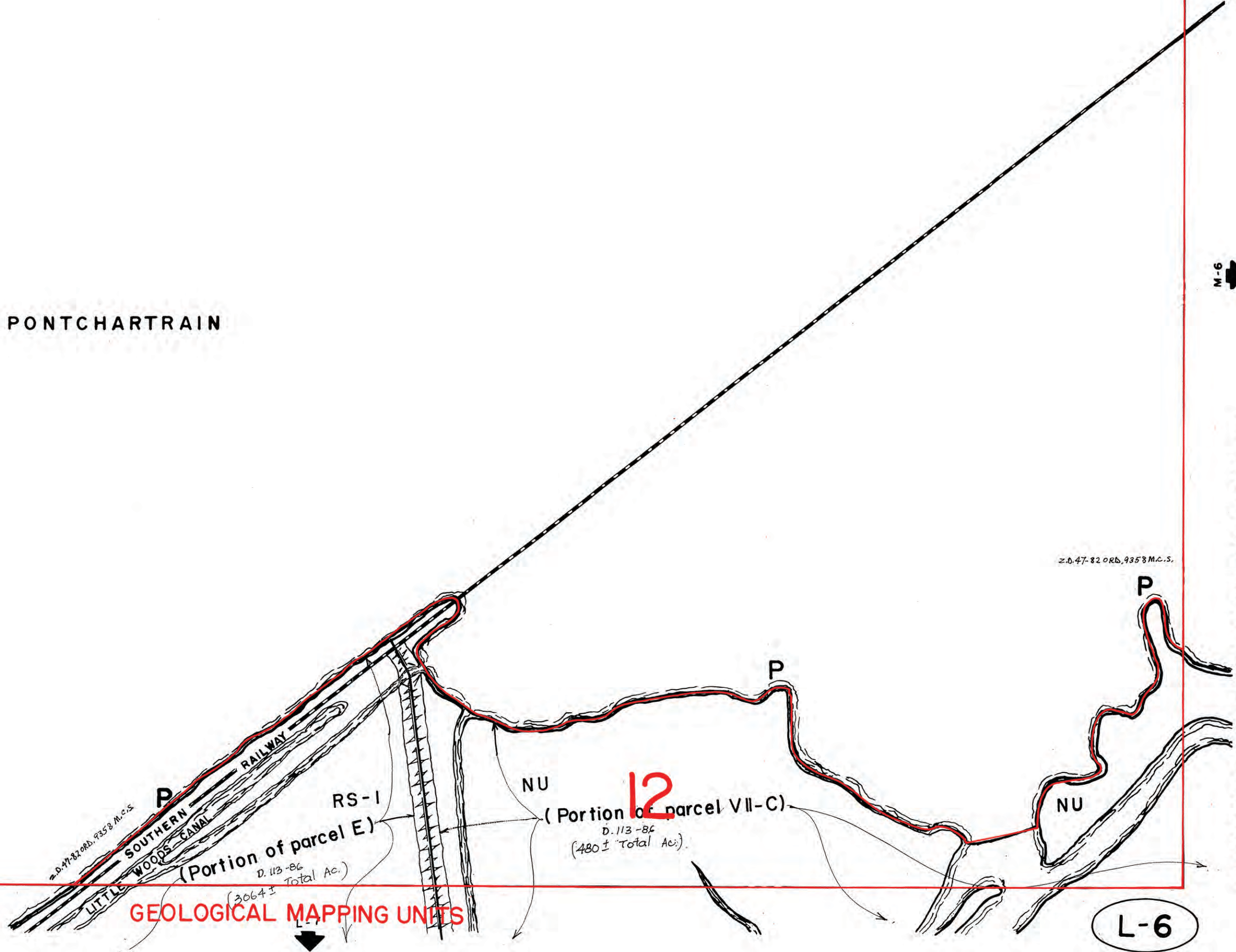
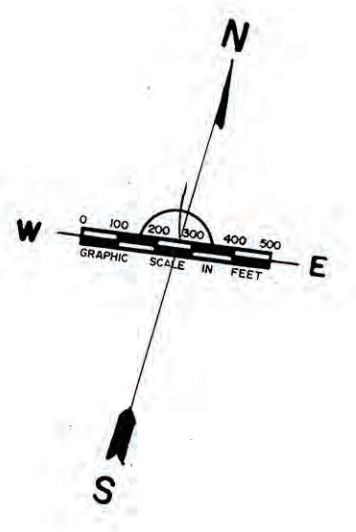

EUSTIS ENGINEERING COMPANY
SOIL AND FOUNDATION CONSULTANTS
METAIRIE, LOUISIANA

GEOLOGICAL MAPPING UNITS

PREPARED BY CITY PLANNING COMMISSION, REVISED 1970
2-5-66 TPL

L-6

K-6

M-6